

PORTA-VAC™ II

Product No. 52905, 52906, 52907

DESCRIPTION:

The Porta-Vac™ II is a continuous vacuum system that runs on a standard 9V battery. ESD-Safe tips lift wafers and other flat items up to 12” and 500 grams.



Figure 1: Porta-Vac™ II

BATTERY REPLACEMENT:

- To remove the rear cap where the 9 Volt Battery is (Figure 3) or the rechargeable battery pack, turn the screw ONE turn counterclockwise until cap is loose (refer to Figure 2).
- Always check the polarity when installing a battery or rechargeable battery pack. The positive terminal shall be installed towards the top of the tool (refer to Figure 4).
- To secure the rear compartment, turn the screw clockwise until it is tight.

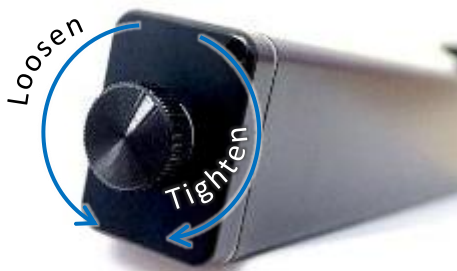

Figure 2: Removing the Cap



Figure 3: 9 Volt Battery

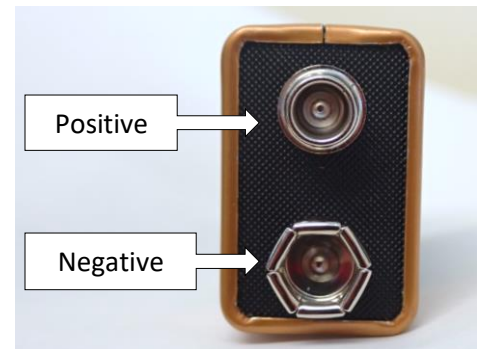

Figure 4: Battery Terminals

APPLICATION:

- To operate the Porta-Vac™ II, press the button to turn the unit ON and release the button to turn it OFF (refer to *Figure 5a*).
- Slight pressure on the button toward the rear may be necessary to prevent the button from locking.
- The battery level indicator light blinks on and off when battery recharge or replacement is necessary (refer to *Figure 5a*). See the following battery selection procedure to set the Porta-Vac™ II for the battery that you are using.
- To lock the Porta-Vac™ II to the “ON” position, press the button down and push forward, then release pressure on the button (refer to *Figure 5b*).
- To unlock and turn OFF Porta-Vac™ II, simply apply pressure to the button and push towards the rear of the tool (refer to *Figure 5c*).

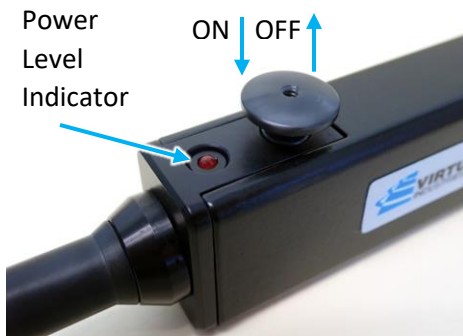

Figure 5a: ON and OFF Controls



Figure 5b: Lock ON Controls



Figure 5c: Unlocking Controls

FILTER REPLACEMENT:

- To replace the air filter, disassemble the unit as shown (*Figure 6*) and reassemble with a new filter. Under normal clean room conditions, the inlet filter should be replaced annually, more often in dustier areas.

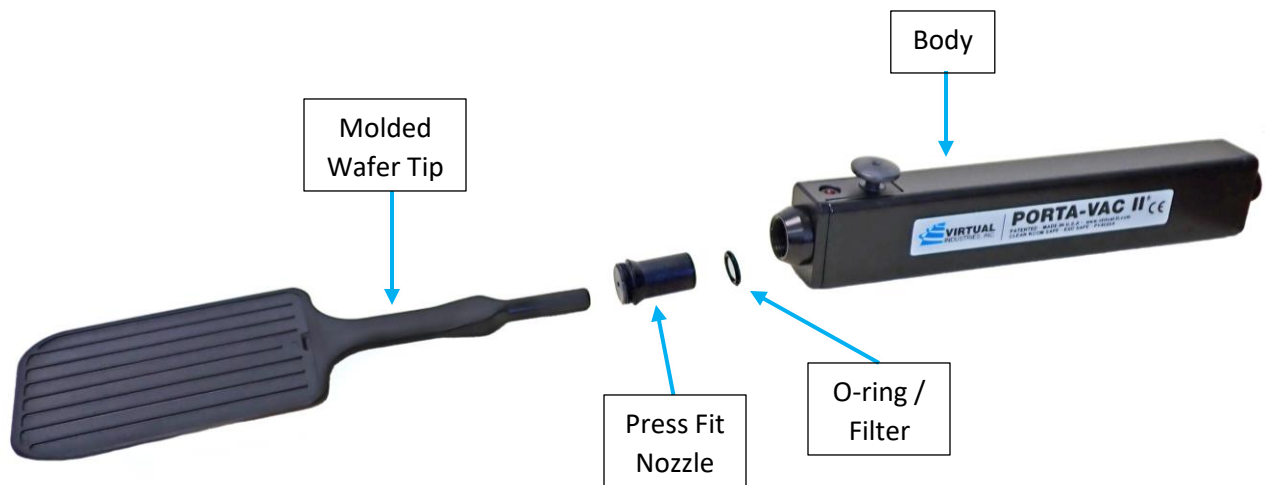

Figure 6: Disassembling Unit to Replace Filter

REPLACEMENT FILTERS:

Set of five replacement 40 micron inlet filters:

- Part number **52920**

CHANGING WAFER TIPS:

- To replace a wafer tip, pull it out of the press fit adaptor and insert the replacement tip into the adaptor.

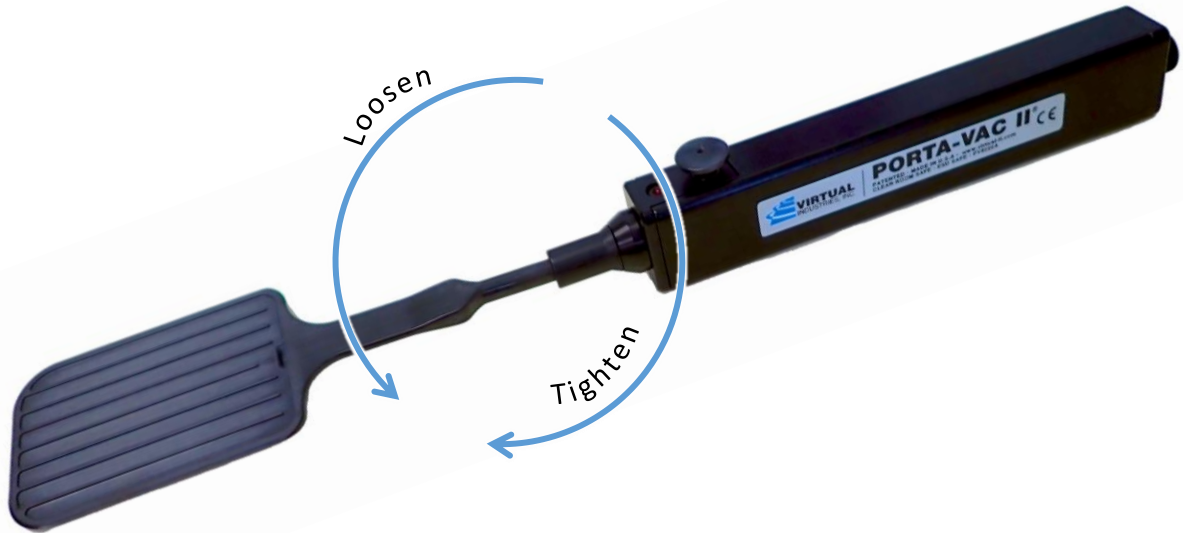

Figure 7: Disassembling Unit to Replace Filter

ON / OFF SWITCH SENSITIVITY ADJUSTMENT:

- If the on/off switch needs to be adjusted (the unit does not shut off or the unit does not hold a part), use a 0.050" hex wrench to adjust the screw inside of the control button.
- Hold the button firmly when making adjustment. Turning clockwise increases the sensitivity when the button is pushed, while counterclockwise has the opposite effect.



Figure 8: Switch Sensitivity Adjustment

SETTING THE BATTERY LOW WARNING:

- The battery selection switch is located on the bottom of the Porta-Vac™ II. To set the unit’s battery low indicator for use with alkaline, carbon or lithium batteries, rotate the battery selector switch one full turn, clockwise. To set the Porta-Vac™ II battery low indicator for use with a nickel metal hydride battery, rotate the battery selector switch one full turn, counterclockwise.

CAUTION: Do not use excessive force when rotating the switch.

NOTE: Factory setting is for standard 9 Volt Battery.



Figure 9: Battery Selection Adjustment

SPECIFICATIONS:

BATTERY TYPE	HOURS
9.6 Volt NiMH	3 to 4
9 Volt Alkaline	12 to 15
9 Volt Carbon	4 to 5
9 Volt Lithium	36 to 40

Vacuum	Minimum of 15 to 20 inches of mercury depending on elevation and atmospheric pressure.		
Dimensions	Length: 8.27" (210mm)	Height: 1.1" (28mm)	Width: 0.8" (20mm)
	Add 0.62" (15.23mm) to the length when using the rechargeable battery pack.		
Weight with Battery	6.58 ounces (186 grams)		

- Selection of Molded PEEK Wafer Tips:** Part numbers 52920-4, 52920-6, 52920-8, and 52920-12
- Variety of Flat Vacuum Handling Attachments:** Part numbers 52920-14, 52920-16, and 52920-18